



DAWNco

Reasonable prices, priceless reasoning.

Model #KLNb.7-PL05

Ku band LNB, input 11.7 to 12.2 GHz, output 950 to 1450 MHz

KLNB

KU-BAND PLL

stability +/- 5 KHz



SPECIFICATIONS

Noise figure	0.7 dB	Conversion gain	60 dB
L.O. stability (after 60 sec)	±5 kHz	Output P1dB	5 dBm
Gain Flatness over freq.	1.5dBp-p @ over 27 MHz	Power requirements	+15 to +24 V supplied through center conductor of IF cable
	4dBp-p @ over 500 MHz	Current drain	200 mA
Gain Variation over temp. (-40°C to +60°C)	6 dBp-p max	Input Waveguide	WR75
Phase noise (SSB)	-75 dBc/Hz at 1 kHz	Dimensions	110 (L) x 42 (W) x 42 (H) mm
	-80 dBc/Hz at 10 kHz		(4.3 x 1.7 x 1.7 in)
	-95 dBc/Hz at 100 kHz	Weight	300 g / 10.6 oz
Input VSWR	2.2 : 1	Temperature Range	-40°C to +60°C
Output VSWR	2.2 : 1		

FREQUENCY BAND

Typical service

Input frequency (GHz)	11.70 to 12.20
L.O. frequency (GHz)	10.75
Output frequency (MHz)	950 to 1450

MECHANICAL DIAGRAM

CONNECTOR	F - 75 Ohm
FREQUENCY	11.70 - 12.20 GHz
NOISE FIGURE	0.7 dB
L.O. STABILITY	±5 kHz

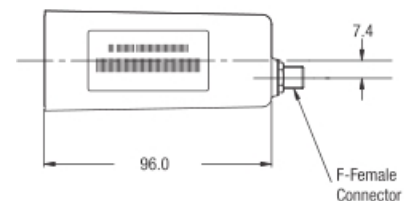
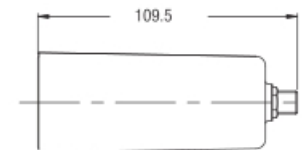
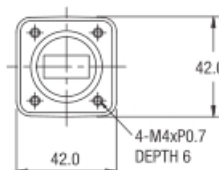

You are entitled to the manufacturer's limited express warranty, if any, that accompanies the product. DAWNco makes no additional or independent warranty. All other warranties, express or implied, including the warranties of merchantability and fitness for a particular purpose are disclaimed. We do our best to be accurate. We are not responsible for any typographical, photographic or technical errors. See "Policies for DAWNco" under the "Answers" button at the button at the DAWNco website.